

Specifications:
 Current rating: 3.0A AC,DC
 Voltage rating: 250V AC, DC
 Contact resistance: 10m ohm Max
 Insulation resistance: 1000M ohm Min
 Withstanding voltage: AC 1,000V AC/minute
 Operating Temperature: -40°C ~ +105°C

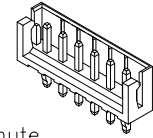

Materials and Finish
 Insulator: Thermoplastic (UL94V-0)
 Insulator Color: White/Blue/Red/Black $\triangle C$
 Contact material: Copper Alloy
 Finish: Tin/Matte Tin Plated

How to Order

2317SEH-XXXX-XX-XX $\triangle B \triangle C \triangle D$
 $\triangle D$ Blank Bag
 $\triangle D$ CR:Cap+Tape&Reel(For 3P~12P)
 $\triangle C$ Blank White
 $\triangle C$ BU:Blue
 $\triangle C$ RD:Red
 $\triangle C$ BK:Black
 $\triangle B$ Blank Tin Plated
 $\triangle B$ MT:Matte Tin Plated
 No. Of Contacts
 Straight Type

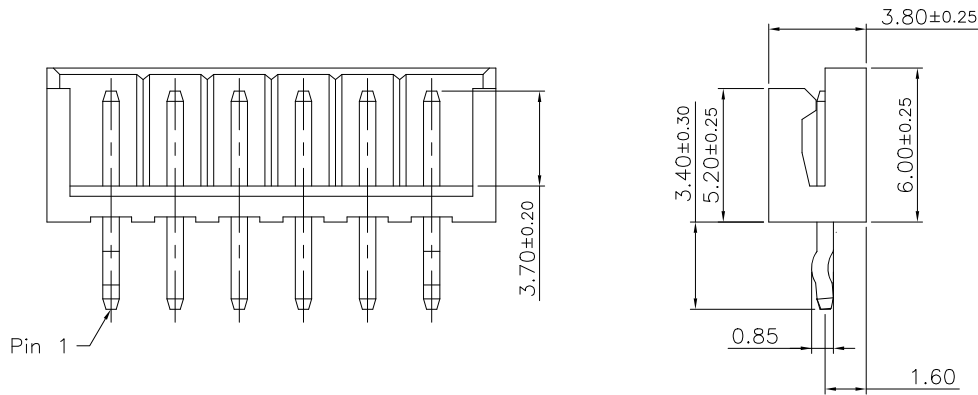

Pin	Dim.A	Dim.B	Dim.C	Dim.D	Pin	Dim.A	Dim.B	Dim.C	Dim.D
2	2.50	6.50	5.70	7.50	8	17.50	21.50	20.70	22.50
3	5.00	9.00	8.20	10.00	9	20.00	24.00	23.20	25.00
4	7.50	11.50	10.70	12.50	10	22.50	26.50	25.70	27.50
5	10.00	14.00	13.20	15.00	11	25.00	29.00	28.20	30.00
6	12.50	16.50	15.70	17.50	12	27.50	31.50	30.70	32.50
7	15.00	19.00	18.20	20.00					

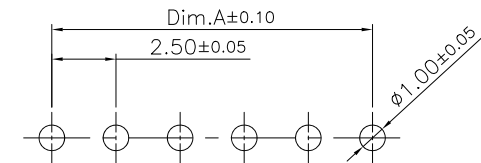

PCB Layout

RoHS Compliant

F				DRAWN:	GENERAL TOLERANCE:	Neltron Industrial Co., Ltd.	DESCRIPTION: 2.50mm Wire To Board Wafer Straight Type	SIZE A4
E			Pingchia	.X=±0.20 .XX=±0.15				
D	07-JUN-2024	Add CR Option	Jamie Chuang	CHECKED:	UNIT: MM			
C	05-MAR-2024	Add Color Options	Lucy Du	Jerry Chen	SCALE: 1:1			
B	25-FEB-2019	Add Matte Tin Plated	Jamie Wang	APPROVAL:	SHEET: 1/1	PART NO:		
A	19-JUN-2017	(P0001)	Pingchia	Mike Wu	PROJECTION:	2317SEH-XXXX-XX-XX $\triangle B \triangle C \triangle D$		
REV	DATE	FILE	BY					